



Drummond Family Activity Room

The Center features exceptional amenities including:

State-of-the-art amenities

- Audio/visual equipment with HD projection
- Assistive-listening devices throughout the four main rooms
- Wi-Fi throughout the building
- LED theater lighting
- Beautiful wood floor and acoustically designed Performance Space

Superior amenities

- Wood sprung dance floor in the Rehearsal Room
- Steinway Grand piano
- Boston Steinway upright piano
- High-top/cocktail tables
- 5 ½-foot round tables*
- Bar and banquet tables*
- Upholstered banquet chairs*
- Wooden floor podiums
- Table podiums

*The Center will provide and set up tables and banquet chairs.

Ample parking is available at the Center with additional parking nearby. Valet parking is available on request.



Greenfield Family Art Room

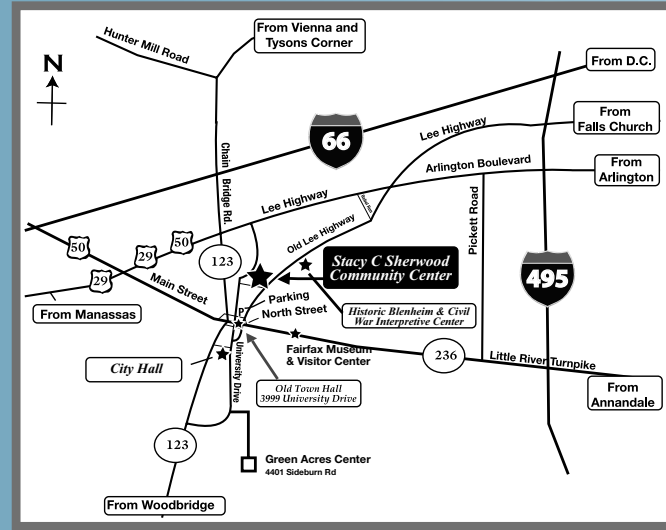

Reserve your event NOW!

Call or e-mail for further information.

T: (703) 385-7858

F: (703) 246-6321

parksrec@fairfaxva.gov

www.fairfaxva.gov/parksrec

www.weddingsinfairfax.com



Reserve your event NOW!

A Venue with Elegance & Style



Stacy C. Sherwood Community Center

3740 Old Lee Highway
Fairfax, VA 22030



Fairfax Rotary Gallery

The Stacy C. Sherwood Community Center, centrally located in the City of Fairfax, is an exceptional venue for all your social, corporate, nonprofit and community events. It's the perfect setting for banquets, receptions, weddings, anniversary and holiday parties, arts and cultural events and business and training meetings.

The Center features beautifully appointed rooms, state-of-the-art audio/visual facilities, assistive-listening devices throughout the four main rooms, wireless access throughout the building, an acoustically designed performance space and a well-equipped caterer's kitchen.

Consider the Sherwood Center for your next event!



Mason Family Rehearsal Room



STEINWAY & SONS



Howard W. Sharpe, Sr. and Helen R. Sharpe Performance Space—Banquet Style



Howard W. Sharpe, Sr. and Helen R. Sharpe Performance Space—Auditorium Style

Choose from any of our flexible rooms

Howard W. Sharpe, Sr. and Helen R. Sharpe Performance Space:

- Divides into two spaces, beautiful wood floor, acoustically designed, theater staging and LED lighting, assistive listening devices, Wi-fi, state-of-the-art AV equipment, Steinway grand piano.*

Mason Family Rehearsal Room:

- Sprung wood dance floor, exercise equipment, full-length wall mirrors with adjustable practice barres, assistive listening devices, Wi-fi, state-of-the-art AV equipment, Steinway Boston upright piano.*

Greenfield Family Art Room:

- Assistive listening devices, Wi-fi, state-of-the-art AV equipment, utility sinks, art supply storage, display boards.

Drummond Family Activity Room:

- Room divider to create smaller meetings and gatherings assistive listening devices, Wi-fi, state-of-the-art AV equipment, adjustable height tables and seating.

* The city is proud to have the center designated as a Steinway venue.



STEINWAY & SONS

Pictures are artist's renditions and do not necessarily represent the amenities available.

Performance Space—Seated Banquet Style



Sherwood Community Center Capacity

- 1. Howard W. Sharpe, Sr. and Helen R. Sharpe Performance Space, Full—5,000 square feet**
Seated auditorium style, chairs only—420
Seated banquet style, chairs and tables—304

Main Hall—Flexible space, divides into two rooms—2,500 square feet each

- Seated auditorium style, chairs only—200
Seated with tables and chairs—108

Performance Space—Seated Auditorium Style

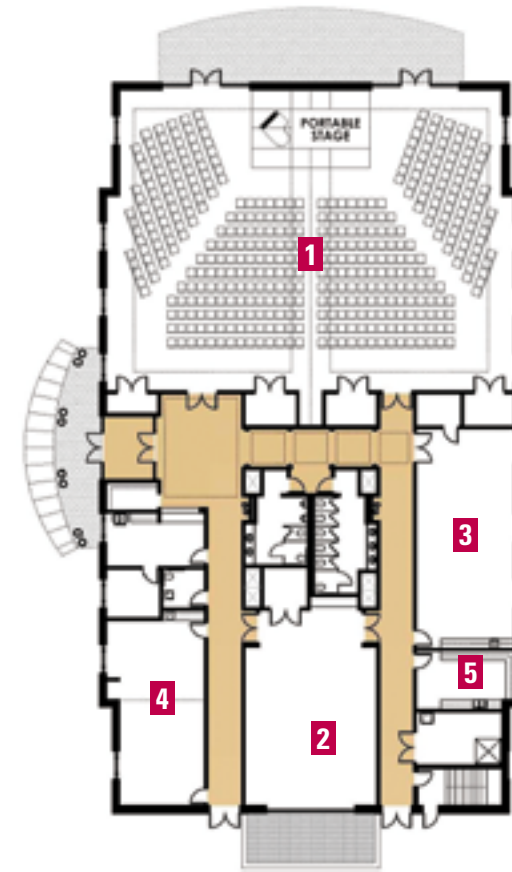

- 2. Mason Family Rehearsal Room—1,061 square feet**
- 3. Greenfield Family Art Room—906 square feet**
- 4. Drummond Family Activity Room—724 square feet**
- 5. Woods-Connolly Catering Corner**

Woods-Connolly Catering Corner

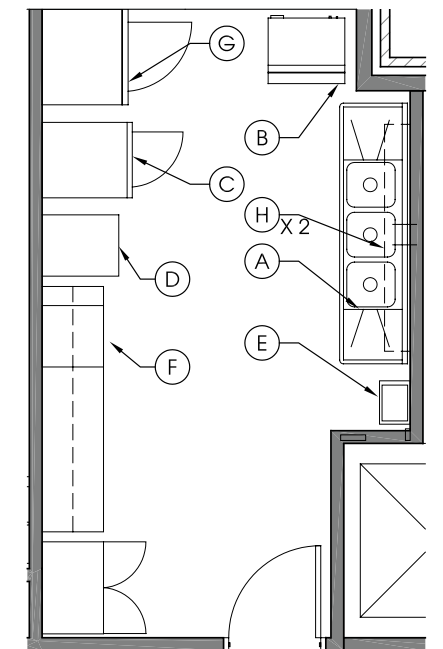

A well-designed and efficiently outfitted caterer's kitchen that includes:

- | | |
|--|--|
| A. Triple-compartment scullery sink | E. Handsink |
| B. Icemaker | F. Countertop microwave |
| C. Dual Temp refrigerator/freezer | G. Top-mount mobile universal server shelf—vented |
| D. Dishwasher | H. Shelf |

Our staff will work with you to select the ideal caterer or event company from our Preferred Vendor list, or you may choose your own.

To be on our Preferred Vendor list, please call (703) 385-7858.